







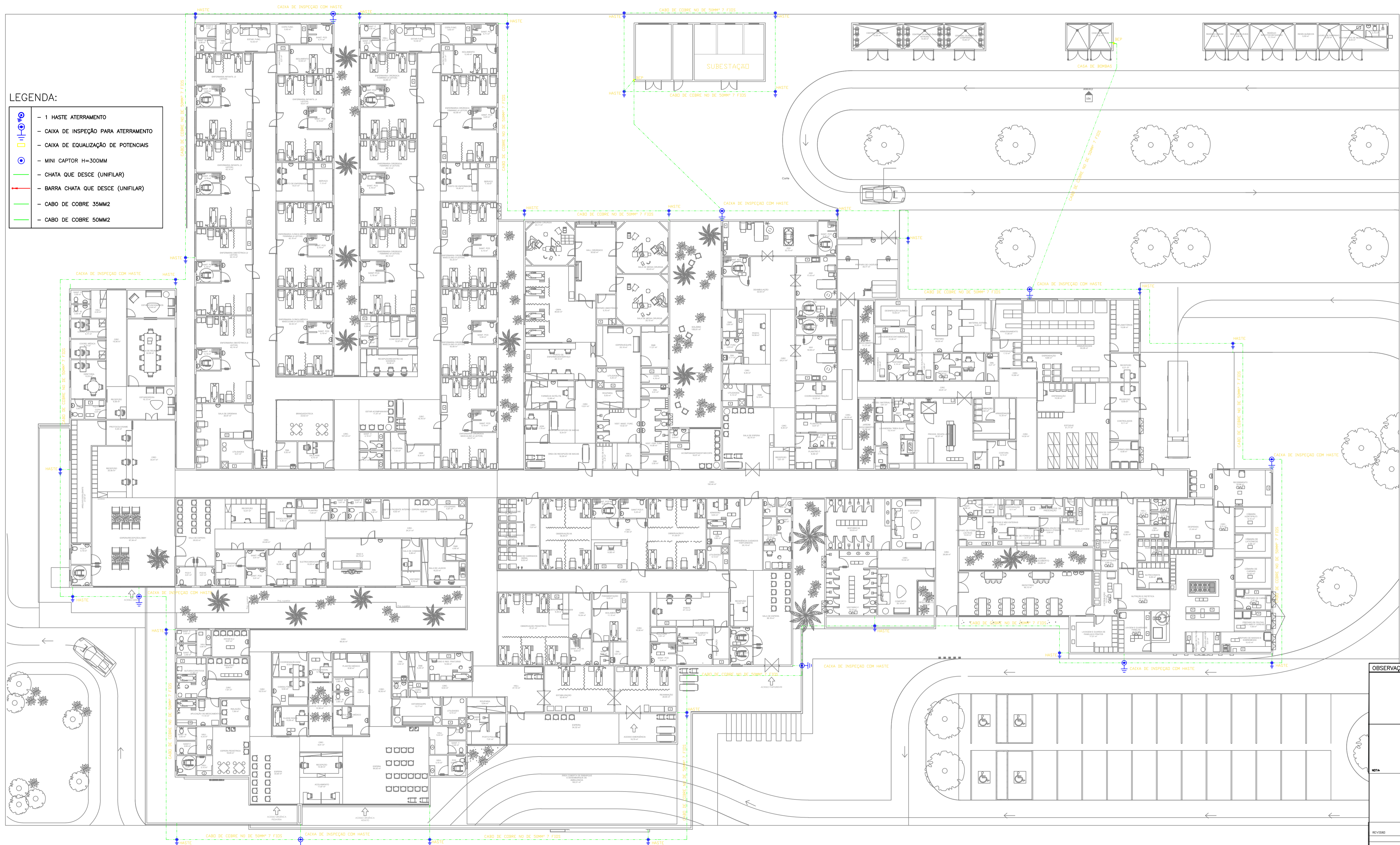

| | |
|---|--------------------------------------|
|  | - 1 HASTE ATERRAMENTO |
|  | - CAIXA DE INSPEÇÃO PARA ATERRAMENTO |
|  | - CAIXA DE EQUALIZAÇÃO DE POTENCIAIS |
|  | - MINI CAPTOR H=300MM |
|  | - CHATA QUE DESCE (UNIFILAR) |
|  | - BARRA CHATA QUE DESCE (UNIFILAR) |
|  | - CABO DE COBRE 35MM2 |
|  | - CABO DE COBRE 50MM2 |



| OBSERVAÇÕES | |
|--|---|
| NOTA: | <p>ASSINATURA RESPONSÁVEL LEGAL</p> <hr/> <p>ASSINATURAS PROJETO - RESPONSABILIZADO</p> <hr/> |
| REVISÃO | <p>ASSINATURA APROVAÇÃO</p> <hr/> |
| <p>SECRETARIA DA SAÚDE DO ESTADO DA BAHIA <small>SECRETARIA DE ATENDIMENTO À SAÚDE</small></p> <p>CAD. HOSPITAL – MARACÁS</p> <p>PROJETO – INSTALAÇÕES ELÉTRICAS</p> <p>ENDERÇO Rua 15 de Julho S/Nº – CENTRO / MARACÁS – BA, CEP: 45.360-000</p> <p>PROJETO EXECUTIVO – ELÉTRICA</p> <p>PLANTA: _____</p> <p>INSTALAÇÕES-A-TERRAMENTO</p> <p>ESCALA: 1/500</p> <p>BATA: UNICED 2024</p> | |